

EASYTEC

Flanged enclosure for modern sensor applications

The new EASYTEC range of wall-mounted enclosures has been optimally designed for the integration of smart sensors for the IIoT (Industrial Internet of Things) and the IoT.

- modern enclosure design with a high degree of stability
- four sizes 80/100/125/150, each in 2 heights
- flame-retardant material ASA+PC-FR and optional protection class IP 65 (seals as accessory) for robust indoor and outdoor applications
- discreet standard off-white color (RAL 9002) supports the wide range of applications – on request we can also produce the enclosures in other colors
- the bottom part has 2 lugs for quick wall mounting or for installation on pipes/round profiles
- tight electronics compartment with two PCB levels (in the top/bottom parts)
- screw connection with stainless steel screws and Torx drive



EASYTEC

Applications and Examples

- IoT/IIoT
- Sensor system
- Environmental technology
- Measurement and control engineering
- Control technology
- Medical and laboratory technology
- Security and monitoring technology
- Information Technology



Automated agriculture



Data logger e.g. for temperature



Data logger with gateway function



Smart store logistics

View Customizing Options

What do you still need for your own very personal product? We can supply enclosures and tuning knobs with all necessary modifications for fitting your electronic components.
Customizing options for Easytec



Machining



Lacquering



Printing



Laser marking



RFI/EMI shielding



Installation / Assembly
of accessories

EASYTEC

Select Versions



C3204107
EASYTEC 80
ASA+PC (UL 94 V-0)
off-white RAL 9002
3.98"x1.97"x0.87"
IP 65 opt., IP 40



C3204207
EASYTEC 80
ASA+PC (UL 94 V-0)
off-white RAL 9002
3.98"x1.97"x1.02"
IP 65 opt., IP 40



C3206107
EASYTEC 100
ASA+PC (UL 94 V-0)
off-white RAL 9002
4.76"x2.44"x1.02"
IP 65 opt., IP 40



C3206207
EASYTEC 100
ASA+PC (UL 94 V-0)
off-white RAL 9002
4.76"x2.44"x1.22"
IP 65 opt., IP 40



C3207107
EASYTEC 125
ASA+PC (UL 94 V-0)
off-white RAL 9002
5.79"x3.07"x1.18"
IP 65 opt., IP 40



C3207207
EASYTEC 125
ASA+PC (UL 94 V-0)
off-white RAL 9002
5.79"x3.07"x1.46"
IP 65 opt., IP 40



C3208107
EASYTEC 150
ASA+PC (UL 94 V-0)
off-white RAL 9002
6.77"x3.66"x1.42"
IP 65 opt., IP 40



C3208207
EASYTEC 150
ASA+PC (UL 94 V-0)
off-white RAL 9002
6.77"x3.66"x1.81"
IP 65 opt., IP 40

Accessory "protection"



A9500030
Sealing 80



A9502030
Sealing 100



A9503030
Sealing 125

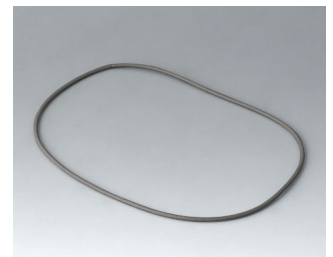

A9504030
Sealing 150

Accessory "screws"



A0305031
Self-tapping screws 0.098" x
0.236" (PZ1)



A0325060
Self-tapping screw 0.098" x
0.236" (T8)
Stainless steel



A0399T08
Torx T8 screwdriver

EASYTEC

Subject to technical modification without notice. © by OKW Gehäusesysteme, Buchen/Germany.