

**B 67 02 100** A-A  
 Vers. I: connection side with free through passage  
 front open  
 2 sides open

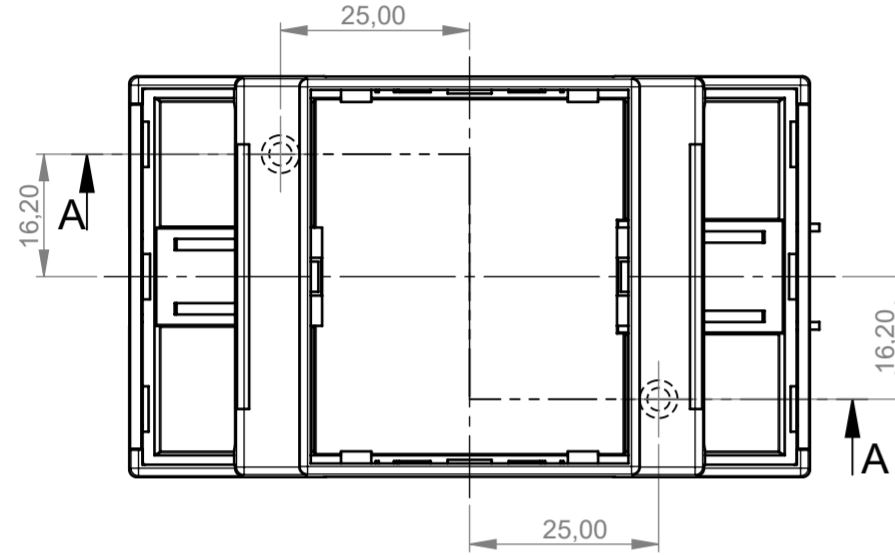

Innenansicht  
 Inside view

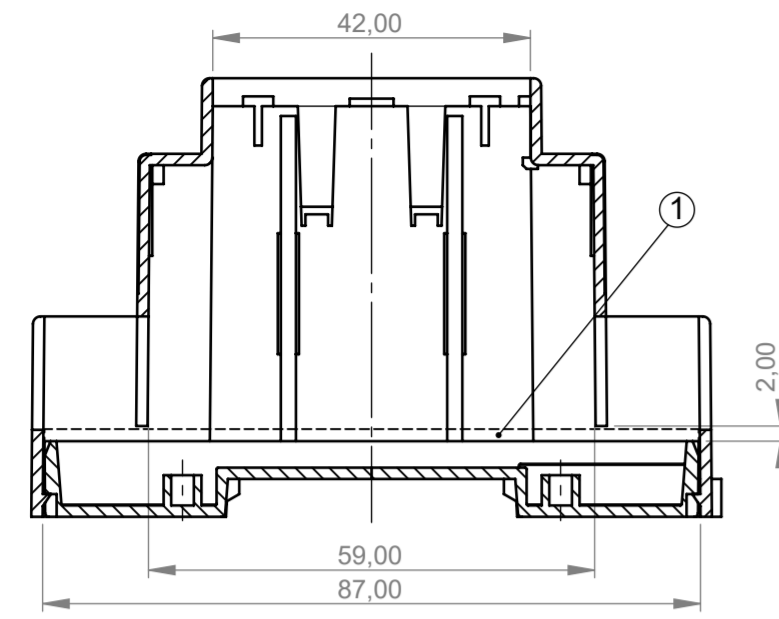
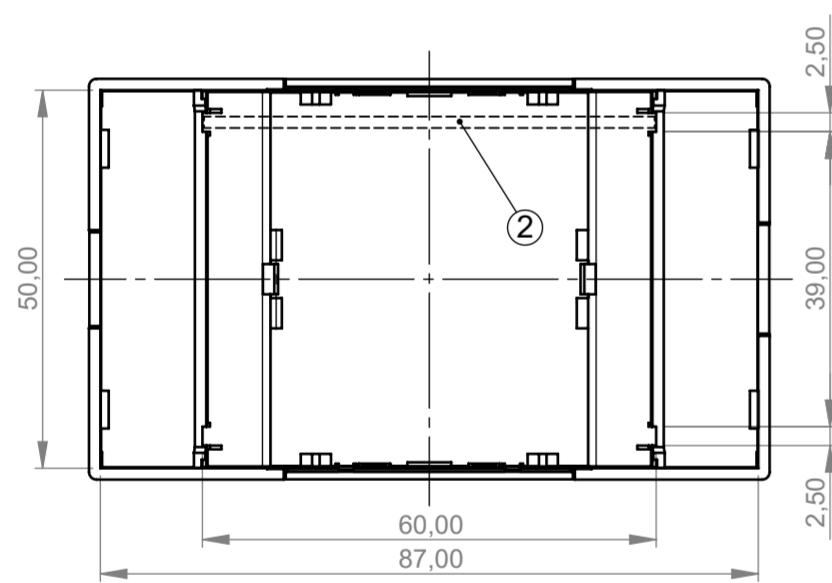

**B 67 02 102** A-A  
 Vers. II: connection side with free through passage  
 front open  
 2 sides open

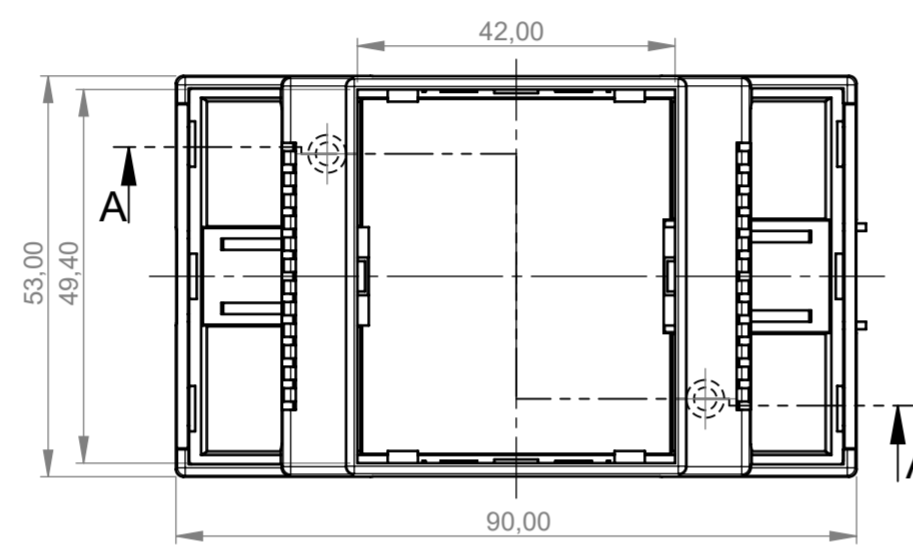
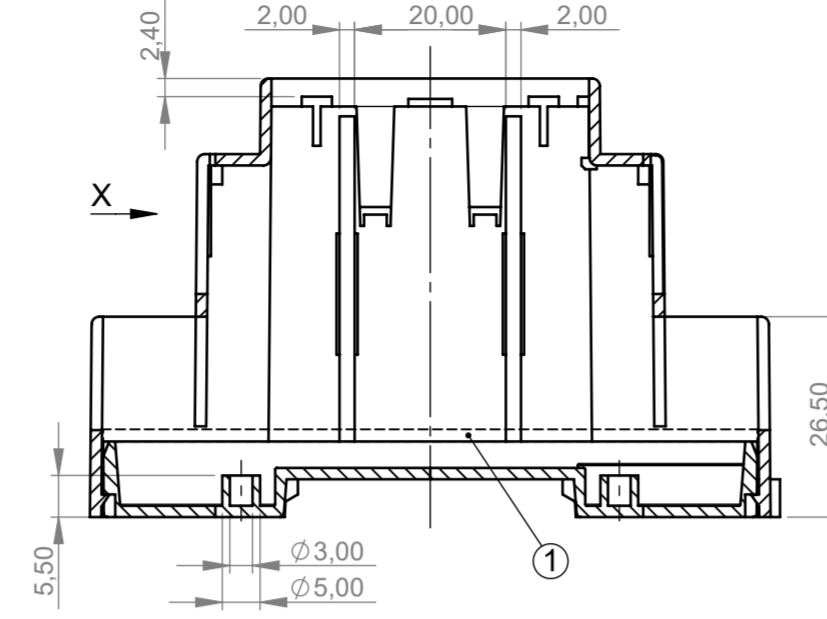

ANSICHT X  
 VIEW

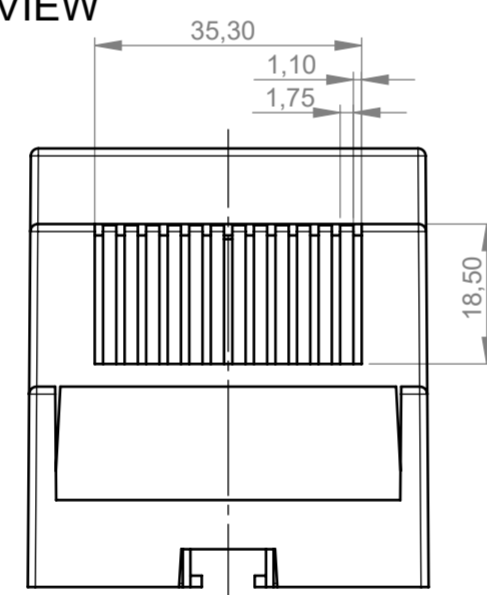

Lüftungsschlitze  
 Ventilations slots

① Platine für Printklemme  
 PCB for terminal block

für Klemmenabdeckung: B 68 00 112  
 B 68 00 113  
 for terminal guards: B 68 00 112  
 B 68 00 113

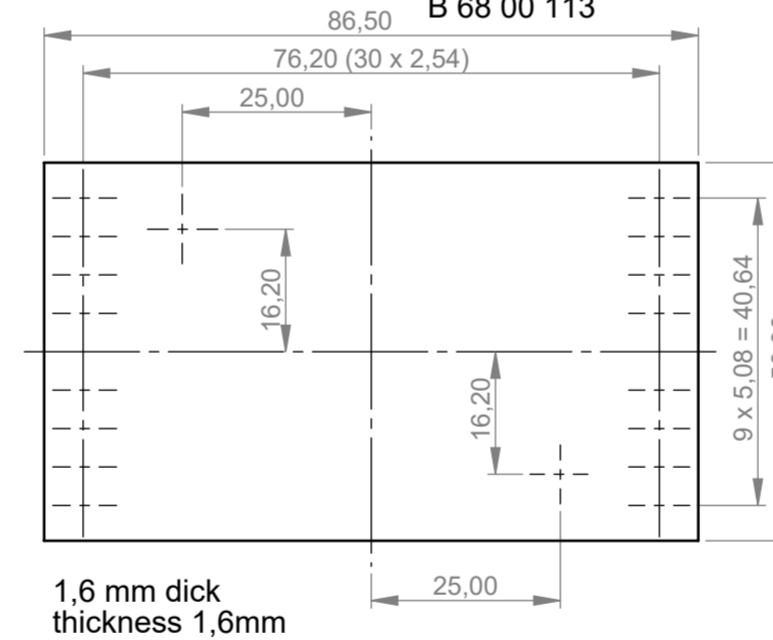

**B 67 02 104** A-A  
 Vers. III: connection side with extended passage  
 front open  
 2 sides open

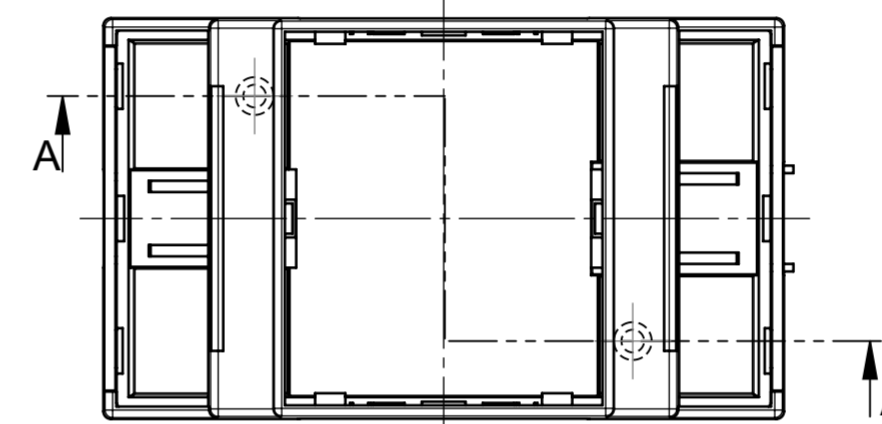
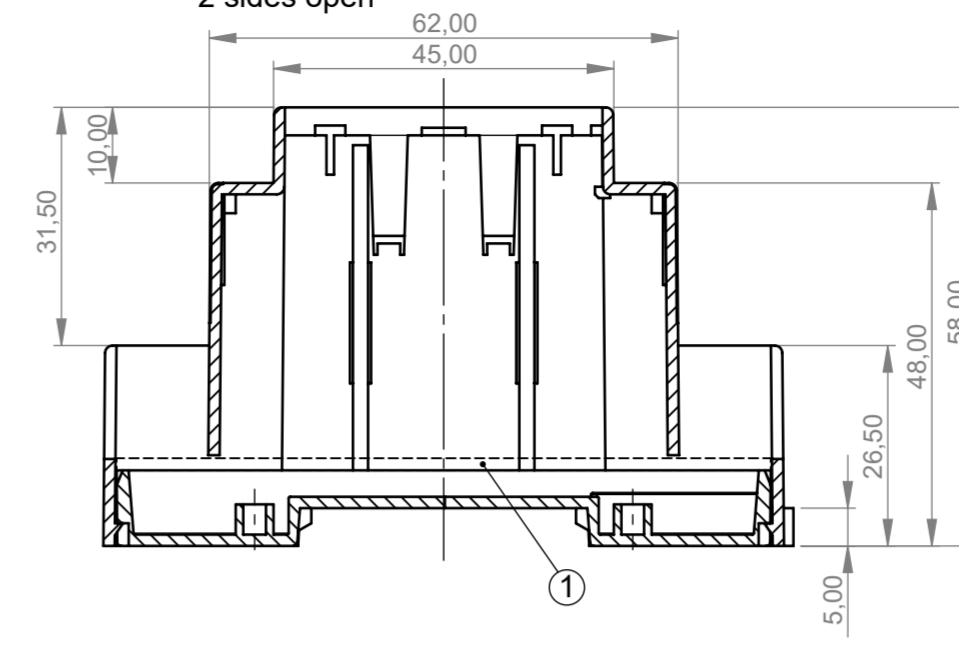

① Platine für Printklemme  
 PCB for terminal block

für Klemmenabdeckung: B 68 00 114  
 for terminal guards: B 68 00 114

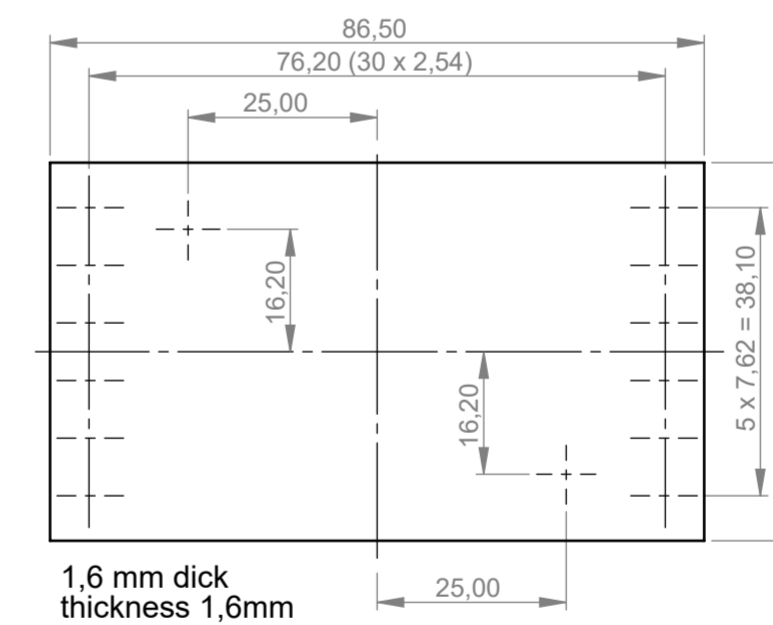

**B 67 02 106** A-A  
 Vers. IV: connection side with free through passage  
 front closed  
 2 sides open

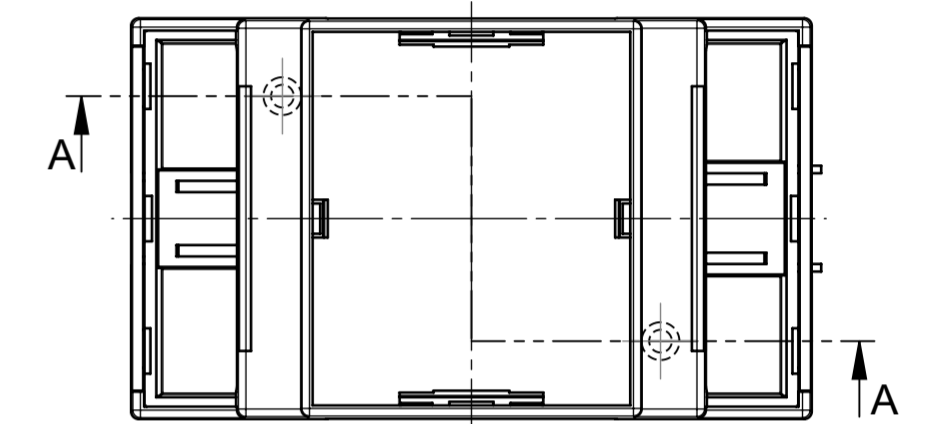
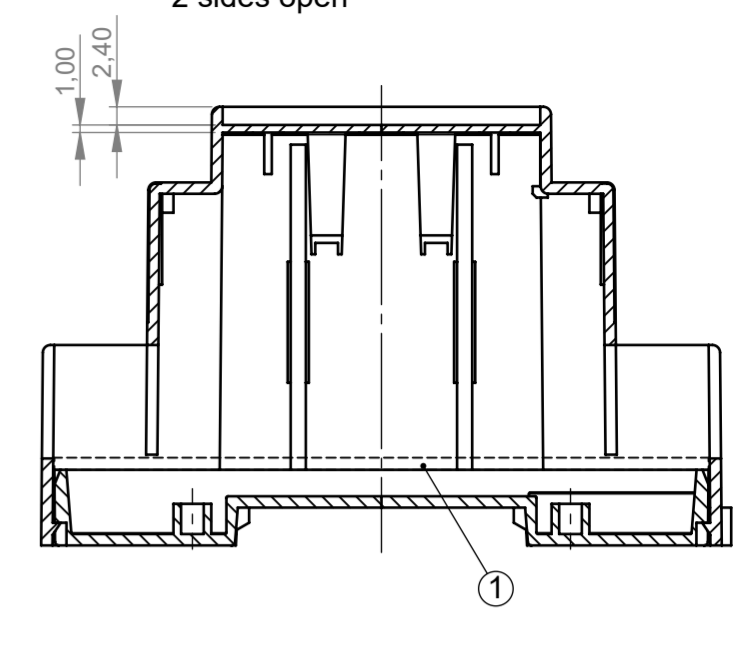

① Platine für Printklemme  
 PCB for terminal block

für Klemmenabdeckung: B 68 00 115  
 for terminal guards: B 68 00 115

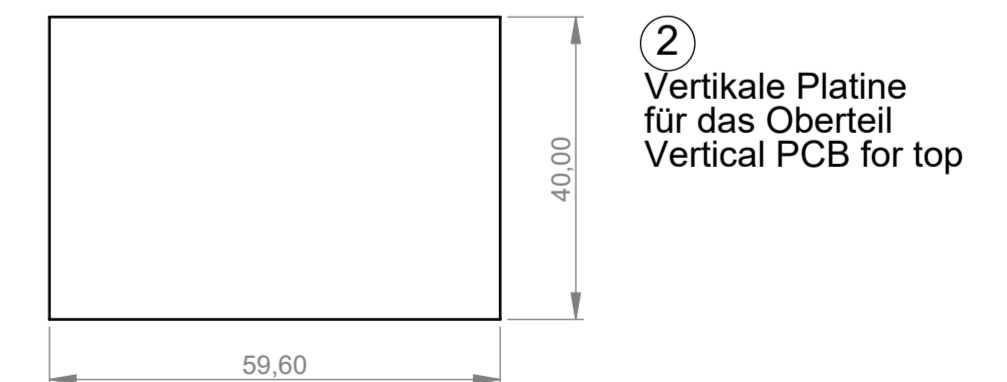
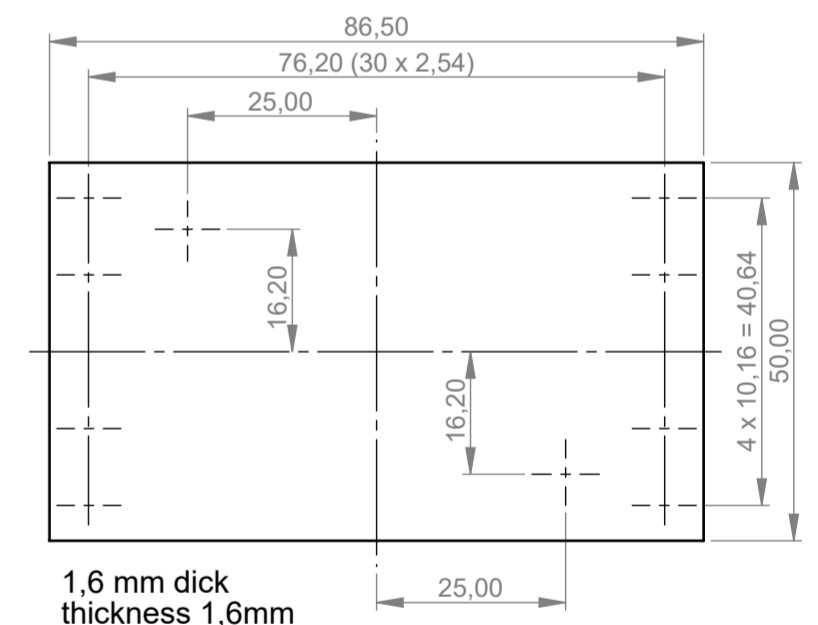

② Vertikale Platine  
 für das Oberteil  
 Vertical PCB for top

Vers. I

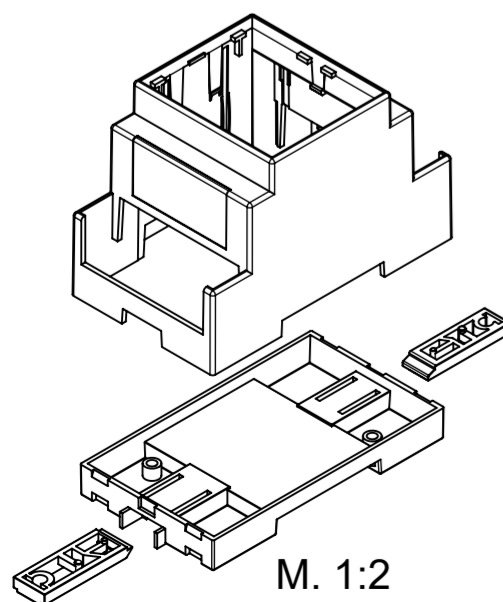

M. 1:2

Vers. II

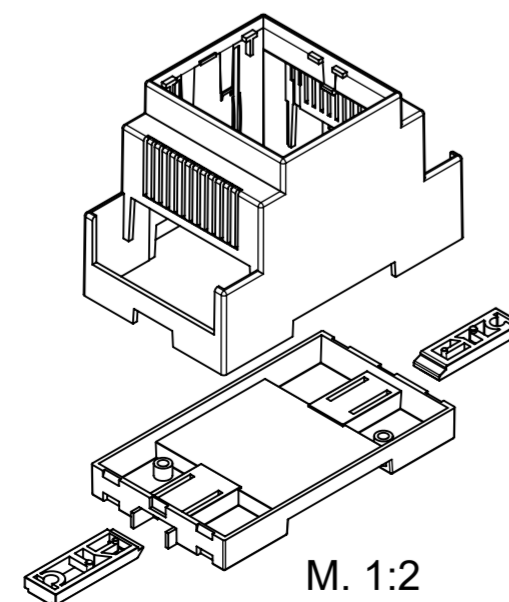

M. 1:2

Vers. III

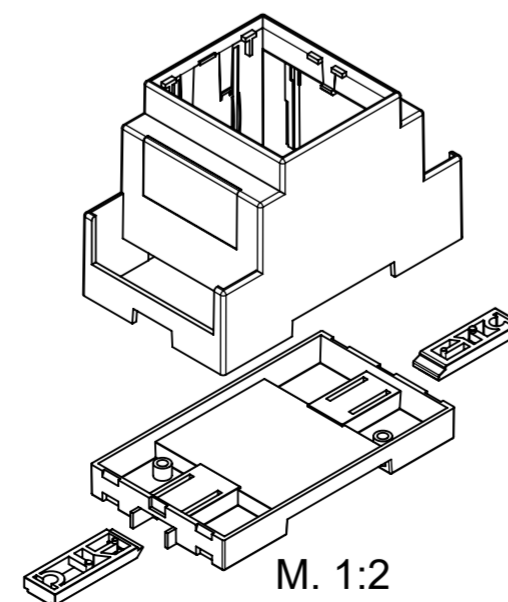

M. 1:2

Vers. IV

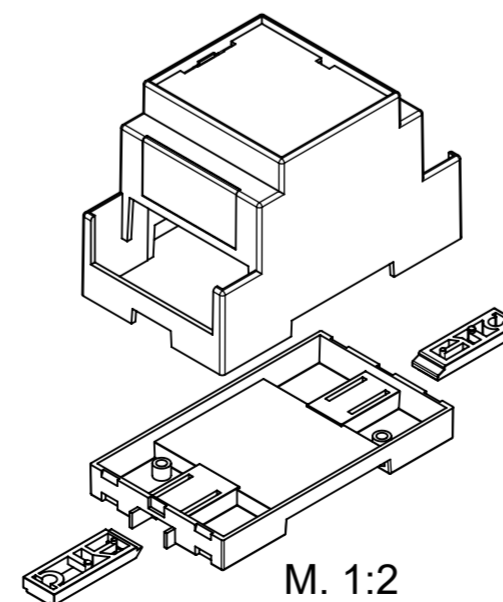

M. 1:2

Bitte die Maße an aktuellen  
 Teilen abnehmen.  
 Diese unterliegen material-  
 und produktionspezifischen  
 Fertigungstoleranzen.

Please take the dimensions  
 from current parts.  
 These are subject to material-  
 and manufacturing-specific  
 tolerances.

Informationskopie  
 wird nicht aktualisiert  
 Copy for Information  
 will not be updated

Technische Änderungen vorbehalten. Irrtümer oder Druckfehler  
 begründen keinen Anspruch auf Schadenersatz. Wichtige Ein-  
 baumaße bitte direkt mit dem aktuellen Produkt abstimmen.  
 Subject to technical modification without prior notice. Typogra-  
 phical and other errors do not justify any claim for damages. All  
 dimensions should be verified using an actual moulded part.  
 Sous réserve de modifications techniques. Toute erreur ou faute  
 d'impression ne justifie aucune demande d'indemnisation. Nous  
 prions les clients de vérifier les dimensions des composants avec  
 les boîtiers avant le montage.

Erst. am: 19.03.2009  
 Erst. von: Hasselb  
 Freig. am: 24.01.2018  
 Freig. von: D. Hasselbach  
 Revision: 02

Toleranzen:  
 DIN 16901 T130  
 Volumen:  
 KUNDE

Status:  
 SERIENFREIGABE  
 Zeichnungsart:  
 KUNDE

OKW  
 GEHÄUSE  
 SYSTEME  
 RAILTEC C 3 Module  
 53 breit, Version I - IV  
 B670210\*

Für dieses Dokument behalten wir uns alle Urheberrechte vor. Es darf auch auszugs-  
 weise weder vervielfältigt noch Dritten in irgendeiner Form zugänglich gemacht werden.

DIN 6 Teil 2

M 1:1

Dateiname:  
 00011301